



Congratulations on your purchase of a new **Symphony Shower Screen!** These instructions will guide you thru the safe installation of your Shower Screen. Please handle the glass panel carefully as tempered glass is difficult to break but is vulnerable if the edges, especially the corners, strike a hard object. And remember the most important safety rule – **Always Wear Your Safety Glasses**. A protective coating of Enduro-Shield™ has been applied to both sides of the glass. The label implies the coating is only on one side – please disregard.

You will need the following Tools:

- Level
- Tape Measure
- Screw Gun with #2 Tip
- Screwdrivers – Phillips and Straight Blade
- Drill with ¼" Bits (check with your hardware store for appropriate bits for your wall type).
- Caulking Gun & Good Grade of Clear Silicone Sealant
- Paper towels & Glass Cleaner

Unpack & Attach The Clips

1

Carefully unpack the glass panel and using the box as a protective pad, stand the panel against the wall as shown. Note the tempering stamp and position the panel with the stamp to the bottom.

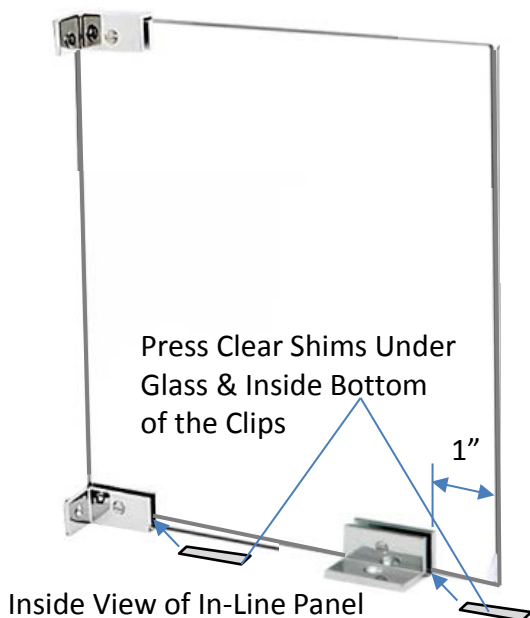

Remove the three clips, clear shims and alcohol wipes from the hardware box. Note there are two thicknesses of shims.

Clean the corners of the glass with an alcohol pad and attach the clips to the fixed panel as shown. Place one of the thinner shims between the bottom of the glass and the bottom clips. Tighten the set screws with a flat-blade screwdriver.

Position the Panel

2

With a helper, place the glass panel in position on the center of the curb. Check the spacing of the screw hole in the clip and the edge of the curb.

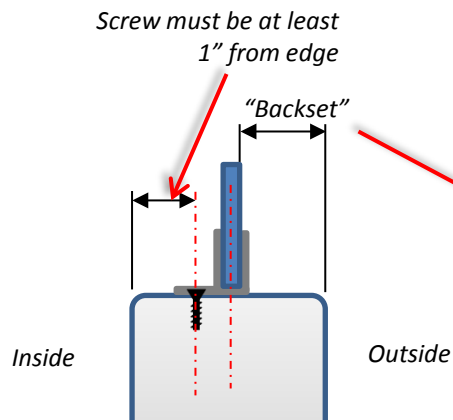

If the space is less than 1 inch move the glass closer to the outside of the curb.

Use a tape measure to position the panel on the "backset" dimension and parallel to the outside of the curb.

Level & Mark

3

Use a level to plumb the panel and mark the three hole positions with a Sharpie™.



Drill

4

Reposition the panel on the protective cardboard and drill the three holes in the marked positions.

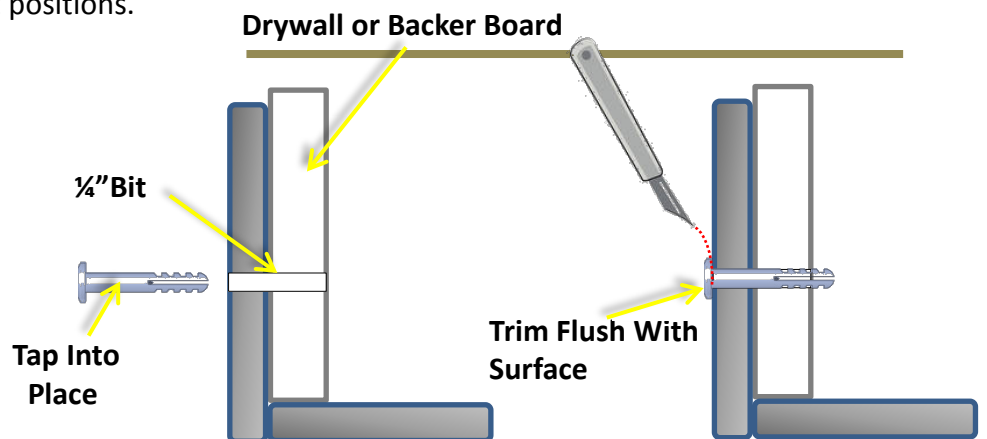
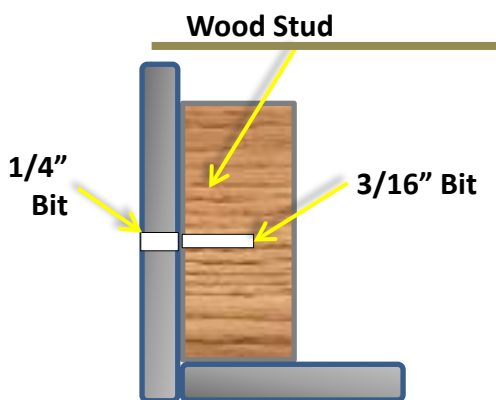

If the drilled holes go directly into a stud, switch to a 3/16" bit to drill the stud. To prevent water infiltration, fill the hole with silicone before installing screws.

If the drilled holes go into drywall or backer board, drill a 1/4" hole, fill the hole with Silicone Sealant and tap the provided wall plug into place with a hammer or mallet. Use a Razor Knife to trim the head of the Wall Plug flush with the surface. This will allow the hardware to lie flat on the wall.

Attach & Adjust the panel

5

Reposition the panel and attach with the three screws provided.

If necessary, loosen the set screws and plumb the panel by adding additional shims to one of the bottom clips. Securely re-tighten the three set screws with a flat screwdriver.

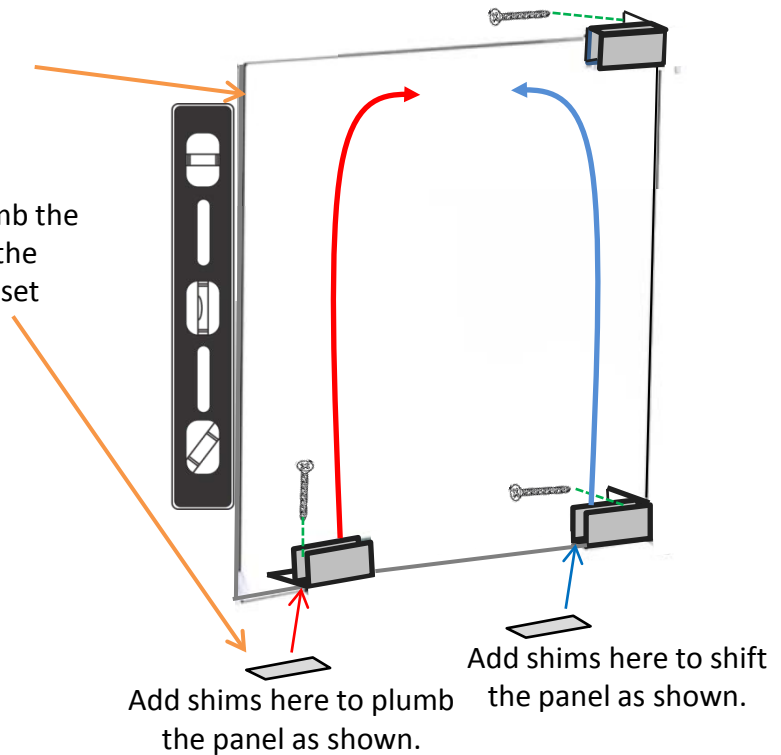

Caulk

6

Using a good grade of clear silicone, seal the interior and exterior of the glass panel. Use the silicone to fill the small gap at the bottom of the panel and any gap between the panel and the wall. If you are not comfortable with your caulking skills, there are number of excellent how-to videos on YouTube.



Do not use the shower for 24 hours to allow the silicone to cure. Once the silicone has cured, Clean your new Symphony door with a soft cloth and glass cleaner. Be sure to remove the Enduroshield™ labels from the glass and follow the instructions to register for the ten year warranty. Refer to the Enduroshield™ website for more detailed cleaning instructions.

Optional Caulk Adaptor

14



If your wall is out of plumb more than 3/8", the gap between your glass panel and the wall may be difficult to caulk. You may want to order the optional Caulk Adaptor.

Please note this is an optional part and should be ordered separately from the website.

A separate instruction sheet is included with the Caulk Adaptor.

